

Wiring diagram 接线图

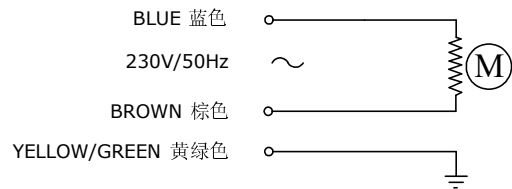

Label 1 铭牌 1

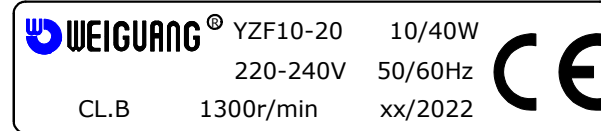

Label 2 铭牌 2



SPECIFICATION 规格说明

MOTOR 电机型式	Shaded pole motor 罩极电动机
MOTOR TYPE 电机型号	YZF10-20
VOLTAGE 额定电压 (V)	230
FREQUENCY 频率 (Hz)	50
INPUT POWER 输入功率 (W)	40
CURRENT 电流 (A)	0.25
SPEED 负载转速 (r/min)	1300
FAN BLADES 负载风叶	Φ230/28°(MAX)
ROTATION 旋转方向	CCW (looking towards the shaft 从轴伸端视去逆时针方向)
AIRFLOW DIRECTION 风向	Sucking or Blowing 通过配不同扇叶实现吹吸风
MOTOR PROTECTION 电机保护方式	Impedance protection 阻抗保护
INSULATION CLASS 绝缘等级	Class B B级绝缘
TEMPERATURE RISE 温升	95K max (with load) 负载运行温升不超过95K
PROTECTION CLASS 防护等级	IP42
OPERATING TYPE 工作定额	S1 连续工作制
MOUNTING TYPE 安装方式	Horizontal or Vertical 垂直或水平安装
AMBIENT TEMPERATURE 适用环境温度	-25°C~+50°C
BEARINGS 轴承型式	Sleeve bearings 含油轴承
ELECTRICAL CONNECTION 电源线	RV 3G 0.5mm ² lead wire 500-550mm free length 电源线长500-550mm, 型号: RV-90 3G 0.5mm ²
HI-POT TEST 耐压测试	1800V/1s I _{leakage} ≤ 0.8mA 1800V/历时1秒, 泄漏电流 ≤ 0.8mA
APPROVALS 认证标记	CE
WEIGHT PER UNIT 单个电机净重	1.1kg
PACKING 包装	24PCS/CTN 24台/箱

	SIGN	DATE
DRN.BY	XIE	29/06/2022
CHD.BY		
ENG.BY		
APP.BY		

TITLE
YZF10-20

PROJECTION

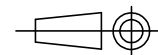

A4

SCALE:
SHEET: 1 of

REV.	DESCRIPTION	APPROVED	DATE
------	-------------	----------	------